

**GATOR SDI**

**614-110295ng1**

GATOR WALL / CEILING LUMINAIRE made of metal, white, satined PMMA opal diffuser light output direct, with converter, IP20

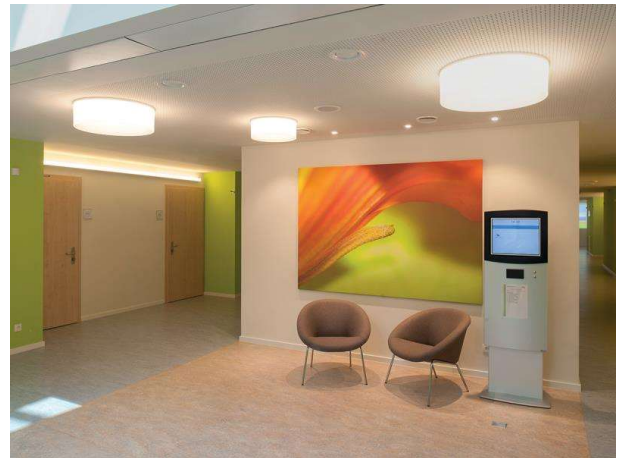

**DRAWING**

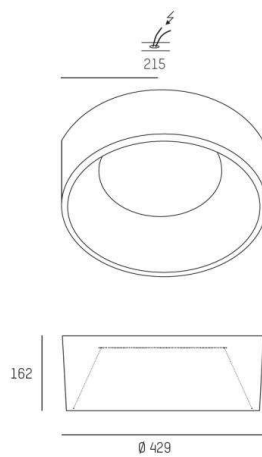

**TECHNICAL DETAILS**

|                       |                            |
|-----------------------|----------------------------|
| System perform. [W]   | 19                         |
| Bulb type             | LED                        |
| Luminous flux [lm]    | 1440                       |
| Colour temp. [K]      | 3000K                      |
| CRI                   | >90                        |
| Optics                | PMMA opal diffuser         |
| Designer              | Serge & Robert Cornelissen |
| Converter             | with converter             |
| Light output          | direct                     |
| Voltage [V]           | 220-240V 50/60Hz           |
| Material              | metal                      |
| Height [mm]           | 162                        |
| Diameter [mm]         | 429                        |
| IP protection class   | IP20                       |
| Voltage class         | protection cl. I           |
| Net weight [kg]       | 3,56585                    |
| Color                 | white                      |
| EAN-Number            | 9008905601842              |
| Lifetime [h]          | 50000                      |
| Energy efficiency cl. | A++-A                      |

**LIGHT DISTRIBUTION CURVE**

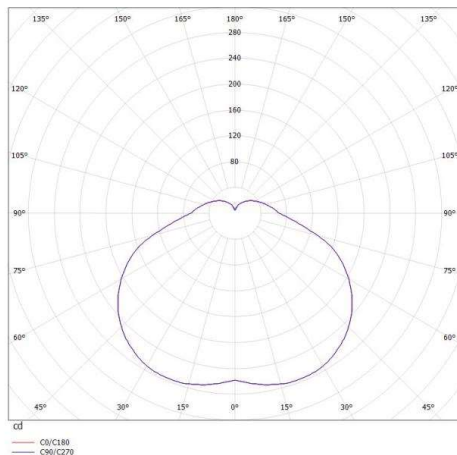

The values are rated values. Power and luminous flux are initially subject to a tolerance of +/- 10%. Colour temperature tolerance: +/- 150 K. The values apply to an ambient temperature of 25°C unless otherwise specified.