



Linea AS-XS(-HE)

SPECIFICATIONS

Beam angle (FWHM)	18° / 37° / 60° (80° on request)
UGR (4H8H 70/50/20)	<19 (18° + 37°)
Fixture material	Die cast aluminium / Glass
Environment	Indoor
IK rate	IK03
Operating temperature (Ta)	-20°C / +45°C ¹
Safety marks	EN60598 / EN62031 / EN 62471
EMC compliance	EN55015
Colour consistency (SDCM)	MacAdam step 3
Warranty	7 years * (within the European Union and the countries of the Free Trade Association for products delivered after 1 May 2015)
Energy class	These products contains a light source of energy efficiency class: CRI97 - F (3000K) & CRI82 - E (3000K) / D (4000K)

This luminaire contains built-in LED lamps. There are no exchangeable parts inside the luminaire. EU 874/2012

¹ In applications with a flat roof (fi. car showrooms) the temperatures may exceed 45°C. Please ask our sales office for a special driver.

Ask our sales department about the possibilities for:
- Extra LED options from the LUXEON Stylist Series

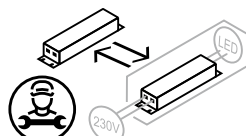

IP20

CRI82/97 VARIATIONS

Linea AS-XS LV 3000K CRI82 3575LM	page 3
Linea AS-XS LV 4000K CRI82 3650LM	page 3
Linea AS-XS LV 3000K CRI97 2150/2500LM	page 3

CRI82 CHOOSE YOUR LV LUMEN OUTPUT

	mA	W	Lumen Output		Lumen / Watt		UGR						Driver types			
			3000K	4000K	3000K	4000K	3000K			4000K			No dim	Dali	Casambi	
							18°	37°	60°	18°	37°	60°				
<i>Special request</i>	500	19,4	2525	2600	130	134								GA-016	PRO-T6i050N	GA
Standard	700	27,9	3575	3650	128	131	14,9	16,0	20,4	15,4	16,4	20,8		GA-016	PRO-T6i050N	GA
<i>Special request</i>	800	32,4	3825	4050	118	125								GA-016	PRO-T6i050N	GA

CRI97 CHOOSE YOUR LV LUMEN OUTPUT

	mA	W	Lumen Output		Lumen / Watt		UGR			Driver types		
			3000K	3000K	3000K	3000K	3000K	No dim	Dali	Casambi		
											18°	37°
<i>Special request</i>	500	17,9	1450		81					GA-016	PRO-T6i050N	GA
Standard	700	27,0	2150		80	14,2	15,2	19,6		GA-016	PRO-T6i050N	GA
Standard	800	32,1	2500		78	14,3	15,3	19,8		GA-016	PRO-T6i050N	GA

DIMENSIONS

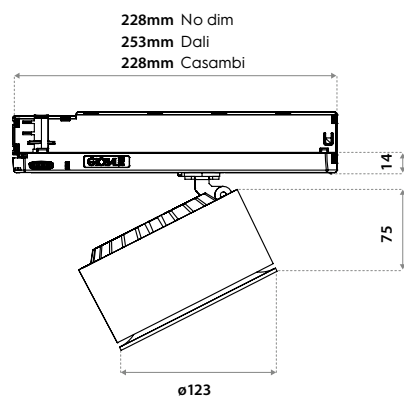

TRACKS

On request! Ask our sales department about the possibilities.

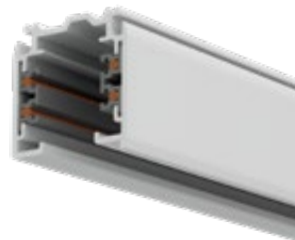

HONEYCOMB ACCESSORY

Description	Type	Item code
Honeycomp filter	By our assembly	009C03BL0000



Reduces the light output by -25% compared to clear glass.

LINEA AS-XS(-HE)

3000K/4000K

ITEM SPECIFICATIONS (PART A)

Description	18°		37°		60°		mA
	Item code	UGR	Item code	UGR	Item code	UGR	
Linea AS-XS-HE 3575Lm 3000K CRI82 No dim	17N403XXHK02	14.9	17N403XXHL02	16.0	17N403XXHM02	20.4	700
Linea AS-XS-HE 3575Lm 3000K CRI82 Dali	17N403XXE402	14.9	17N403XXE502	16.0	17N403XXE602	20.4	700
Linea AS-XS-HE 3575Lm 3000K CRI82 Casambi	17N403XXJ402	14.9	17N403XXJ502	16.0	17N403XXJ602	20.4	700
Linea AS-XS-HE 3650Lm 4000K CRI82 No dim	17N403XXHN02	15.4	17N403XXHP02	16.4	17N403XXHQ02	20.8	700
Linea AS-XS-HE 3650Lm 4000K CRI82 Dali	17N403XXE702	15.4	17N403XXE802	16.4	17N403XXE902	20.8	700
Linea AS-XS-HE 3650Lm 4000K CRI82 Casambi	17N403XXJ702	15.4	17N403XXJ802	16.4	17N403XXJ902	20.8	700
Linea AS-XS 2500Lm 3000K CRI97 No dim	170403XXHG02	14.3	170403XXHH02	15.3	170403XXHJ02	19.8	800
Linea AS-XS 2150Lm 3000K CRI97 Dali	170403XXEI02	14.2	170403XXE202	15.2	170403XXE302	19.6	700
Linea AS-XS 2150Lm 3000K CRI97 Casambi	170403XXJ102	14.2	170403XXJ202	15.2	170403XXJ302	19.6	700

ITEM SPECIFICATIONS (PART A)

Description	W	Lm	Lm/W	CRI (typ.)	Pf	Ripple	Inrush current	B-16A Fuse	Safety class	Energy class
Linea AS-XS-HE 3575Lm 3000K CRI82 No dim	27,0	3575	111	82	0.97	<3%	5A 50µS	50	I	E
Linea AS-XS-HE 3575Lm 3000K CRI82 Dali	27,0	3575	111	82	0.97	<3%	5A 50µS	50	I	E
Linea AS-XS-HE 3575Lm 3000K CRI82 Casambi	27,0	3575	111	82	0.97	<3%	5A 50µS	50	I	E
Linea AS-XS-HE 3650Lm 4000K CRI82 No dim	27,0	3650	126	82	0.97	<3%	5A 50µS	50	I	D
Linea AS-XS-HE 3650Lm 4000K CRI82 Dali	27,0	3650	126	82	0.97	<3%	5A 50µS	50	I	D
Linea AS-XS-HE 3650Lm 4000K CRI82 Casambi	27,0	3650	126	82	0.97	<3%	5A 50µS	50	I	D
Linea AS-XS 2500Lm 3000K CRI97 No dim	32,1	2500	78	97	0.95	<3%	5A 50µS	50	I	F
Linea AS-XS 2150Lm 3000K CRI97 Dali	27,0	2150	80	97	0.97	<3%	5A 50µS	50	I	F
Linea AS-XS 2150Lm 3000K CRI97 Casambi	27,0	2150	80	97	0.97	<3%	5A 50µS	50	I	F

ITEM SPECIFICATIONS (PART C)

Description	Weight	Dimensions single carton	Quantity per carton	Expected lifespan B10 reported (25°C)		
				L70B10	L80B10	L90B10
Linea AS-XS	840 gr	251x241x123mm	12 pcs	>60.500 hrs	>60.500 hrs	>60.500 hrs

NEW STANDARDS REQUIRE NEW LEDS

TM-30 (new color norm): The Illuminating Engineering Society (IES) has published a new Technical Memorandum – TM-30-15 entitled “IES Method for Evaluating Light Source Color Rendition” – that promises to supplant CRI as a color metric. TM-30 relies on separate fidelity and gamut metrics, as well as a set of color samples that is more representative of real-world objects, as opposed to the pastel samples that were primarily used for the baseline CRI metric that was sometimes called Ra. The new color metric is intended to fairly and accurately characterize both LED-based solid-state lighting (SSL) and legacy sources.



Desaturated

CRI = 82 / R_g = 94



Red-Enhanced

CRI = 97 / R_g = 103

HIGH CRI LED OPTIONS

	CCT	CRI	R9	RF	RG	DOWNLIGHTS SMALL			DOWNLIGHTS LARGE		DOWNLIGHTS LARGE		BRAND	ITEM CODE
						MA	LM	LM/W	MA	LM	MA	LM		
CRI82	2700K	82	5	83	94	350	1650	128	700	3400	1200	5300	Bridgelux ksf	51-4087-27
CRI82	3000K	82	7	86	95	350	1725	134	700	3575	1200	5550	Bridgelux ksf	51-4087-30
CRI82	4000K	82	18	84	96	350	1750	136	700	3650	1200	5800	Bridgelux ksf	51-4087-40
CRI90	2700K	92	67	88	104	350	1550	118	700	3150	1200	4700	Bridgelux ksf	51-4088-27
CRI90	3000K	92	67	92	99	350	1600	122	700	3250	1200	4850	Bridgelux ksf	51-4088-30
CRI90	4000K	92	78	92	100	350	1625	124	700	3300	1200	4925	Bridgelux ksf	51-4088-40
CRI97	2700K	97	93	96	103	350	1150	83	800	2300	1400	3425	Lumileds	50-3031-27
CRI97	3000K	97	96	95	103	350	1250	91	800	2500	1400	3750	Lumileds	50-3031-30
CRI97	4000K	97	96	95	103	350	1350	98	800	2700	1400	4050	Lumileds	50-3031-40

2700K

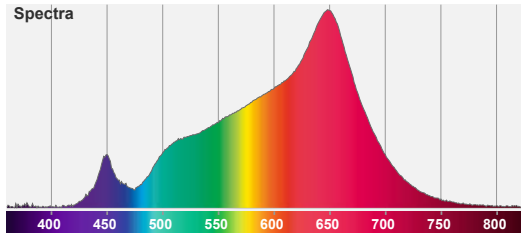
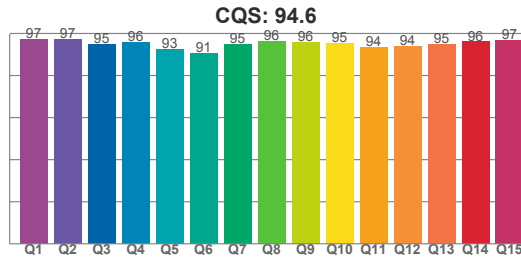
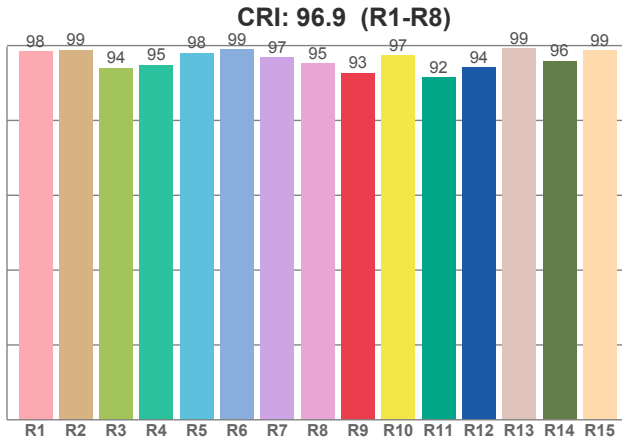

CCT	CRI	CRI R9	TM30 Rf	TM30 Rg	CQS
2700K	96.9	92.7	96.0	102.6	94.6

3000K

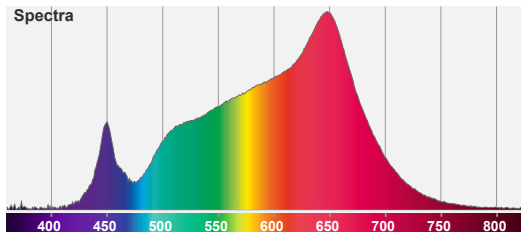
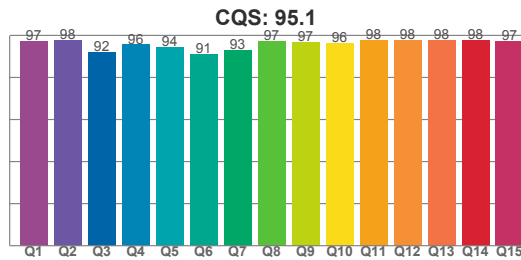
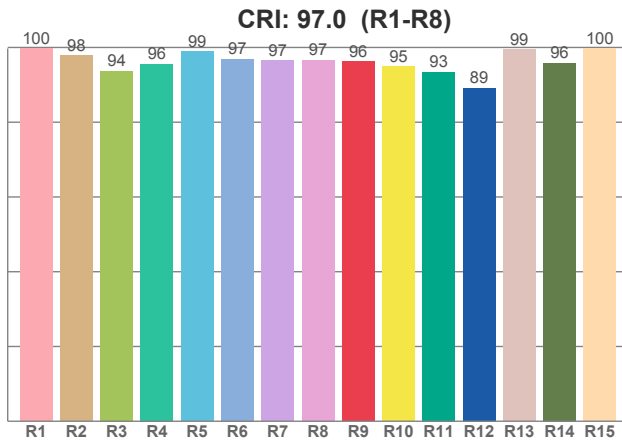

CCT	CRI	CRI R9	TM30 Rf	TM30 Rg	CQS
3000 K	97.0	96.2	95.0	103.3	95.1

4000K

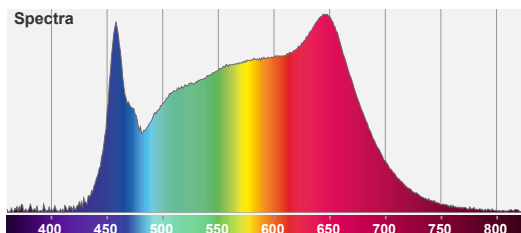
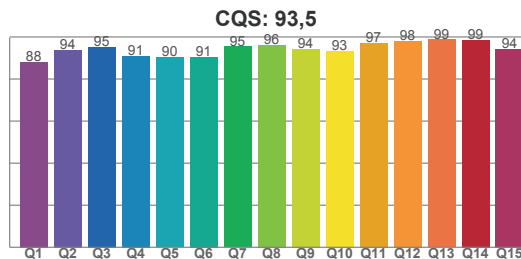
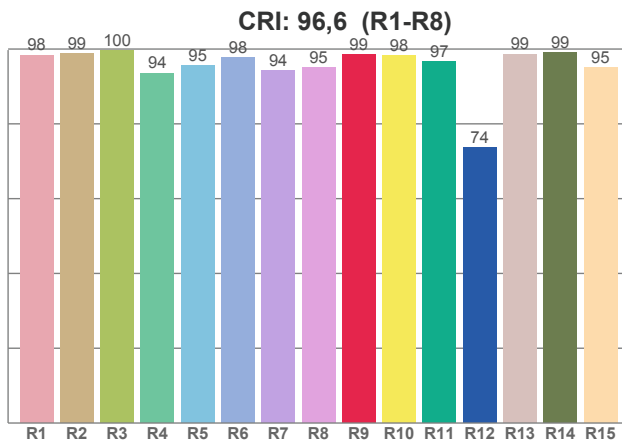

CCT	CRI	CRI R9	TM30 Rf	TM30 Rg	CQS
4000K	96.6	98.5	88.3	96.2	93.5