



BROKIS®



CM16985

MEMORY

CEILING OVAL 300, 350 / PC1333, PC1334



COMPONENTS INCLUDED WITH UNIT:

1× glass shade
1× metal fixture
1× metal string pull
1× installation manual

WARNING:

**Installation must be carried out by
a qualified electrician only.**

**Switch off power at main circuit panel prior to
installation!**

**The manufacturer assumes no liability for
damage occurring during transport or
resulting from incorrect installation.**

Installation time: 30 minutes / 1 person



BROKIS®

BROKIS S.R.O.
ŠPANELOVA 1315/25
163 00 PRAHA 6 - ŘEPY
CZECH REPUBLIC

ORG. ID 64940799
VAT ID CZ64940799
C 42174 MĚSTSKÝ SOUD
V PRAZE

TEL +420 567 211 517
TECHNICAL@BROKIS.CZ
INFO@BROKIS.CZ
WWW.BROKIS.CZ



CLEANING THE GLASS

BROKIS upholds only the highest possible quality standards. Prior to shipping, the light undergoes several quality controls and stages of cleaning. Because transportation, storage, and the amount of time that passes between packing at our plant and subsequent unpacking by the client can affect the light in different ways, we strongly recommend cleaning it prior to assembly.

The glass must first be rinsed in warm water, and a dish detergent may be used to remove all foreign particles, dust, and grease. Repeat the process if necessary and then dry the glass thoroughly with a paper towel.

Recommendation: Do not use mineral spirits, highly concentrated thinners, or other substances not intended for use on glass surfaces. Do not use any cleaning agents containing silicone, as they may leave a film and attract dust and smudges.

PRIOR TO SHIPPING, THE FUNCTIONALITY OF EACH LIGHT AND ITS COMPONENTS IS THOROUGHLY TESTED. THE MANUFACTURER ASSUMES NO LIABILITY FOR THE MISHANDLING OF PRODUCTS.



1. MOUNTING THE METAL FIXTURE

Using anchors of sufficient strength (not included), secure the metal fixture to the ceiling. With regard to various types of ceilings, we recommend consulting installation with an expert. The manufacturer assumes no liability for incorrect installation, the use of improper anchors, or defects in the material to which the light is secured.

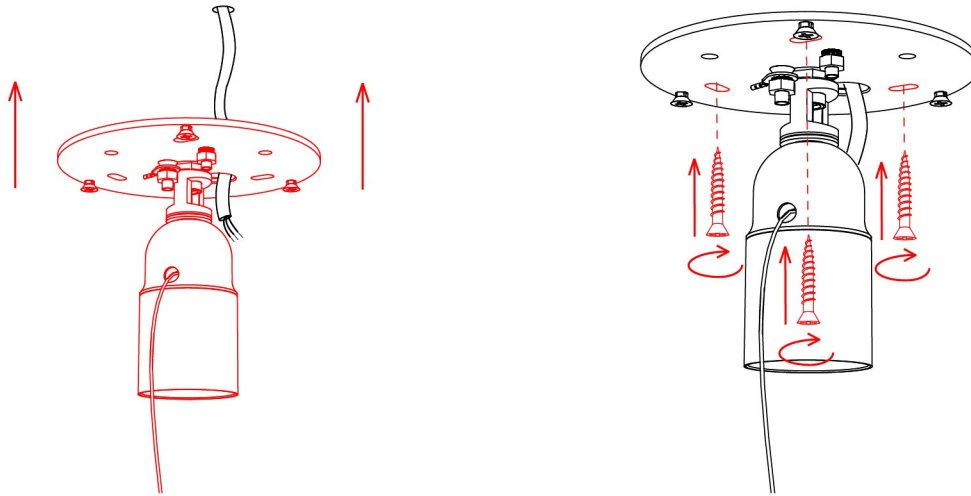

2. ELECTRICAL CONNECTION

Connect the light to the building wiring according to the connection diagram.

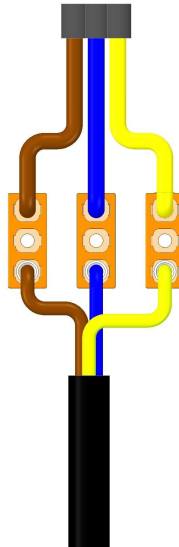

3. INSTALLING THE LIGHT SOURCE

Install the light source (not included).

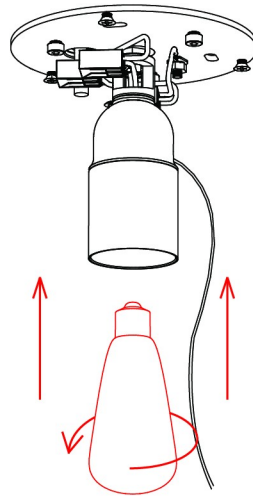

4. ATTACHING THE SHADES

Pass the string hanging from the metal light fixture through first the large opening and then the small opening in the glass shade.

Connect the ground wire with FASTON terminal to the shade mounting ring.

Position the glass shade on the metal light fixture so that the screws pass through the openings in the shade mounting ring. Gently rotate the glass shade clockwise until it is secured firmly to the metal light fixture. If rotation is not smooth, do not use force. Reposition the glass shade and start again.

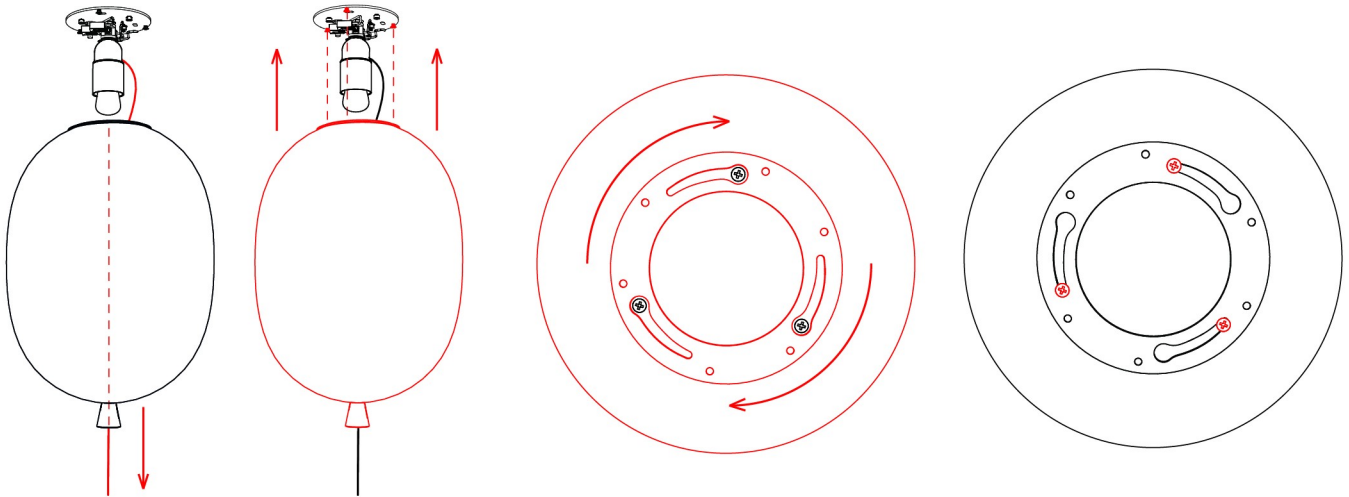

5. INSTALLING THE METAL STRING PULL

Pass the string through the metal string pull and secure with a knot.

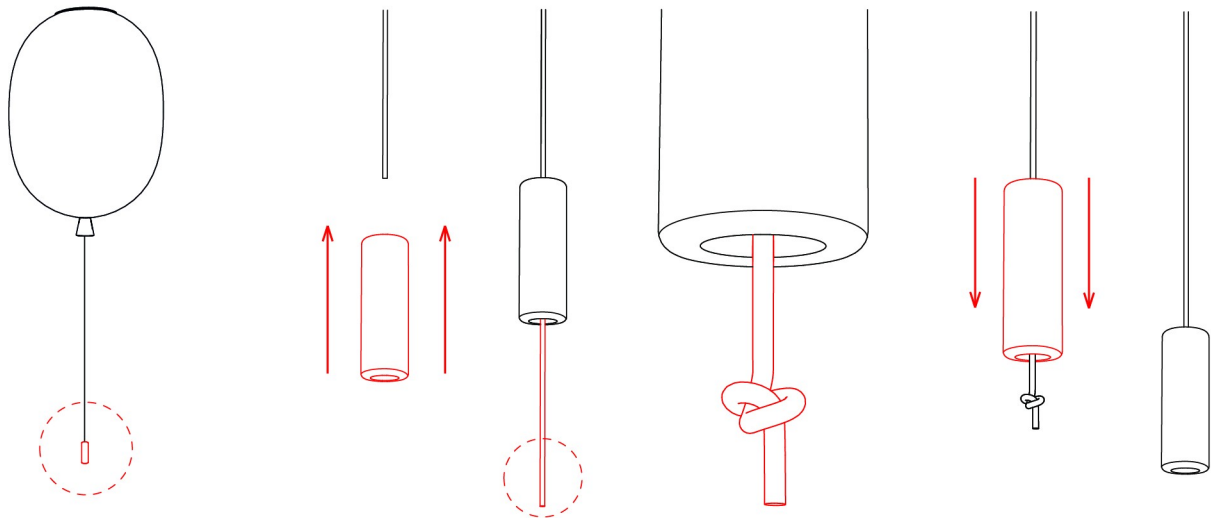

6. SWITCHING ON THE LIGHT

Restore power at the main circuit panel and verify that the light works properly.

