

BROKIS®

OVERLAY

WALL L DOUBLE - PC1302

CM17299

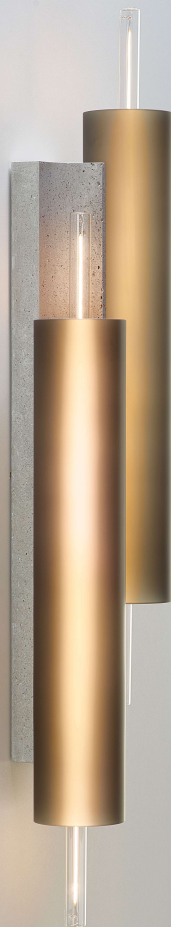



Download

COMPONENTS INCLUDED WITH UNIT:

1× light
2× glass shade
2× light source
4× hand screw M4×16
1× pair cotton gloves
1× installation manual

WARNING:

Installation must be carried out by a qualified electrician only.

Switch off power at main circuit panel prior to installation!

The manufacturer assumes no liability for damage occurring in transport or resulting from incorrect installation.

Installation time: 45 minutes / 2 persons



BROKIS®

BROKIS S.R.O.
ŠPANIELOVA 1315/25
163 00 PRAHA 6 - ŘEPY
CZECH REPUBLIC

ORG. ID 64940799
VAT ID CZ64940799
C 42174 MĚSTSKÝ SOUD
V PRAZE

TEL +420 567 211 517
TECHNICAL@BROKIS.CZ
INFO@BROKIS.CZ
WWW.BROKIS.CZ



CLEANING THE GLASS

BROKIS upholds only the highest possible quality standards. Prior to shipping, the light undergoes several quality controls and stages of cleaning. Because transportation, storage, and the amount of time that passes between packing at our plant and subsequent unpacking by the client can affect the light in different ways, we strongly recommend cleaning it prior to assembly.

The glass must first be rinsed in warm water, and a dish detergent may be used to remove all foreign particles, dust, and grease. Repeat the process if necessary and then dry the glass thoroughly with a paper towel.

Recommendation: Do not use mineral spirits, highly concentrated thinners, or other substances not intended for use on glass surfaces. Do not use any cleaning agents containing silicone, as they may leave a film and attract dust and smudges.

PRIOR TO SHIPPING, THE FUNCTIONALITY OF EACH LIGHT AND ITS COMPONENTS IS CHECKED THOROUGHLY. THE MANUFACTURER ASSUMES NO LIABILITY FOR THE MISHANDLING OF PRODUCTS.



1. INSTALLING THE BRACKET

With regard to various types of walls and their age, we recommend consulting installation with an expert. The manufacturer assumes no liability for incorrect installation or defects in the material to which the bracket is secured.

Pull the building wire through the hole in the bracket and, using anchors of sufficient strength (not included), secure the bracket to the wall.

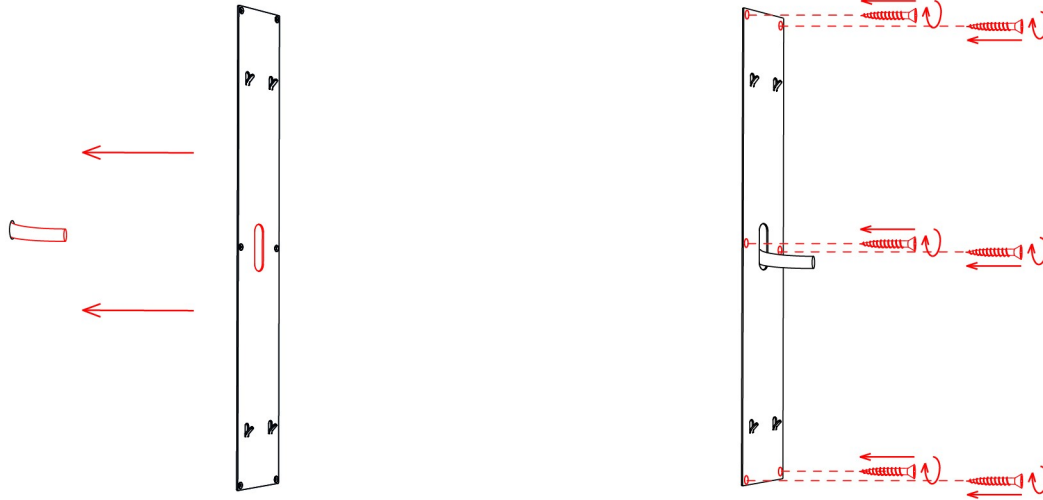

2. INSTALLING THE LIGHT

Position the light over the hooks on the bracket and then slide it downward to secure it in place.

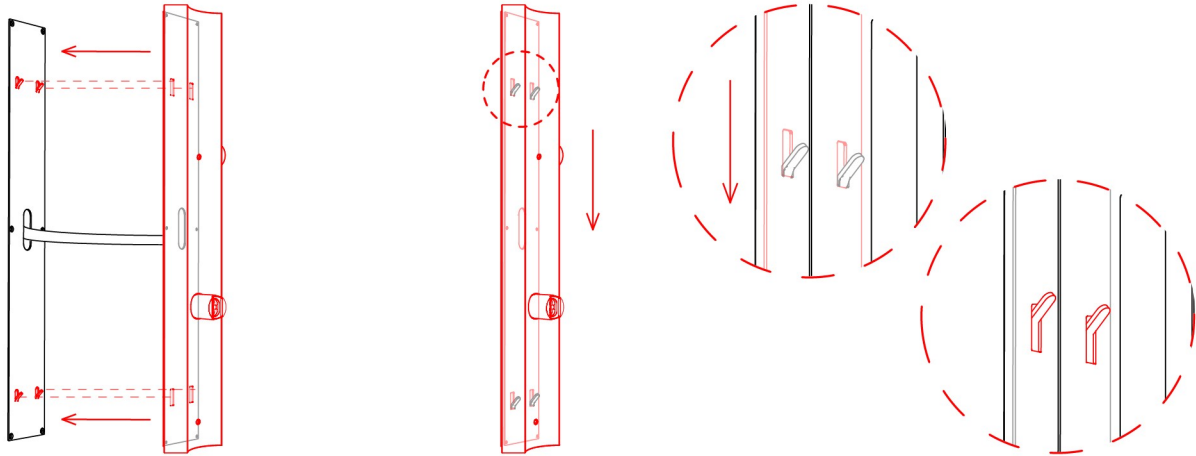

3. ELECTRICAL CONNECTION

Connect the light to the building wiring according to the connection diagram.

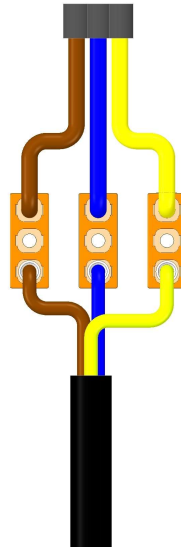

4. ASSEMBLING THE LIGHT 1

With the holes facing the light, position one of the glass shades on the left side of the bracket and use two of the M4×16 hand screws to secure it in place.

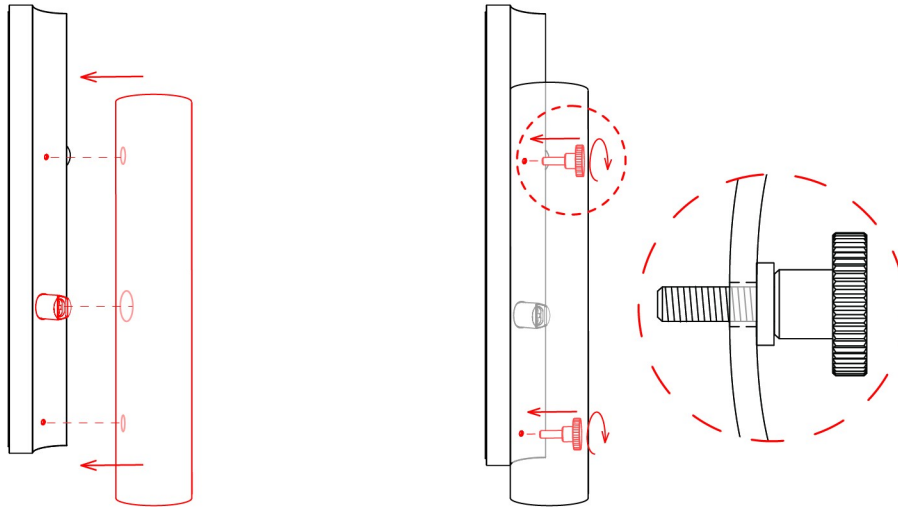

5. ASSEMBLING THE LIGHT 2

With the holes facing the light, position the other glass shade on the right side of the bracket and use the remaining two M4×16 hand screws to secure it in place.

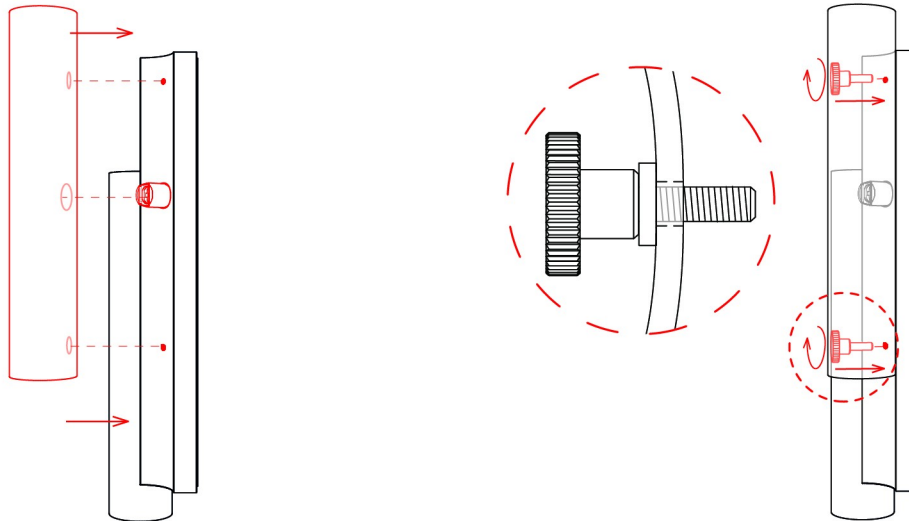

6. INSTALLING THE LIGHT SOURCE 1

Slide the light source into the glass shade. Taking great care not to damage it, press gently and evenly on the light source to seat it in the socket.

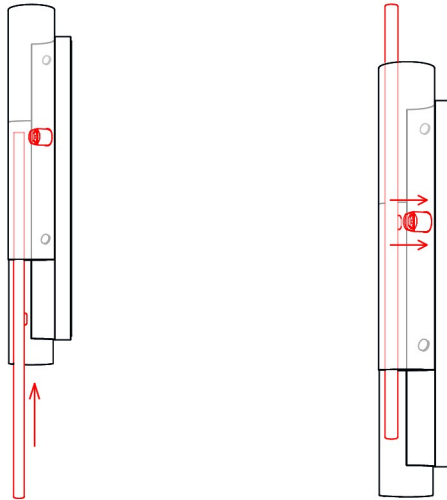

7. INSTALLING THE LIGHT SOURCE 2

Slide the other light source into the second glass shade. Taking great care not to damage it, press gently and evenly on the light source to seat it in the socket.

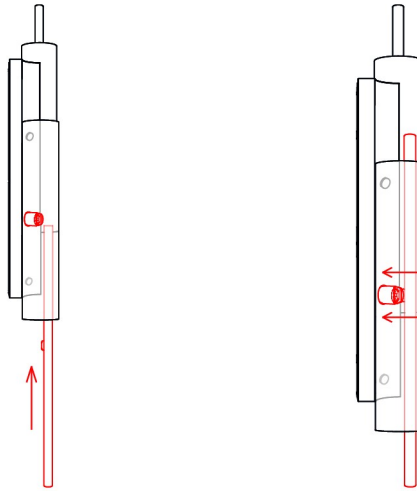

8. SWITCHING ON THE LIGHT

Restore power at the main circuit panel and verify that the light works properly.

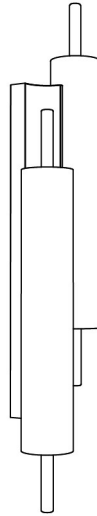

9. REMOVING THE LIGHT SOURCE

First lift one end of the light source and then the other to free it from the socket. Gently slide the light source out of the glass shade.

