



CM16060

PRISMA

FLOOR S 600 - PC1316

FLOOR L 800 - PC1317



Download

COMPONENTS INCLUDED WITH UNIT:

1× metal fixture
1× glass shade
1× pair cotton gloves
1× installation manual

WARNING:

The manufacturer assumes no liability for damage resulting from incorrect assembly.

When unpacking the light, do so with regard for its material composition – the main components are made of glass.

Wear the cotton gloves included with the light when unpacking and assembling it.

IF THE EXTERNAL FLEXIBLE CABLE OF THIS LIGHT IS DAMAGED, FOR SAFETY REASONS IT MUST ONLY BE REPLACED BY THE MANUFACTURER, A TECHNICIAN AUTHORIZED BY THE MANUFACTURER, OR A PERSON WITH THE SAME QUALIFICATIONS.

Installation time: 10 minutes / 1 person



BROKIS®

BROKIS S.R.O.
ŠPANELOVA 1315/25
163 00 PRAHA 6 - ŘEPY
CZECH REPUBLIC

ORG. ID 64940799
VAT ID CZ64940799
C 42174 MĚSTSKÝ SOUD
V PRAZE

TEL +420 567 211 517
TECHNICAL@BROKIS.CZ
INFO@BROKIS.CZ
WWW.BROKIS.CZ



CLEANING THE GLASS:

BROKIS upholds only the highest possible quality standards. Prior to shipping, the light undergoes several quality controls and stages of cleaning. Because transportation, storage, and the amount of time that passes between packing at our plant and subsequent unpacking by the client can affect the light in different ways, we strongly recommend cleaning it prior to assembly.

The glass must first be rinsed in warm water, and a dish detergent may be used to remove all foreign particles, dust, and grease. Repeat the process if necessary and then dry the glass thoroughly with a paper towel.

Recommendation: Do not use mineral spirits, highly concentrated thinners, or other substances not intended for use on glass surfaces. Do not use any cleaning agents containing silicone, as they may leave a film and attract dust and smudges.

PRIOR TO SHIPPING, THE FUNCTIONALITY OF THE LIGHT AND ITS COMPONENTS ARE CHECKED THOROUGHLY. THE MANUFACTURER ASSUMES NO LIABILITY FOR THE MISHANDLING OF PRODUCTS.



1. INSTALLING THE SHADE 1/2

Lift the levers inside the metal fixture to the upright position in order to insert the shade.

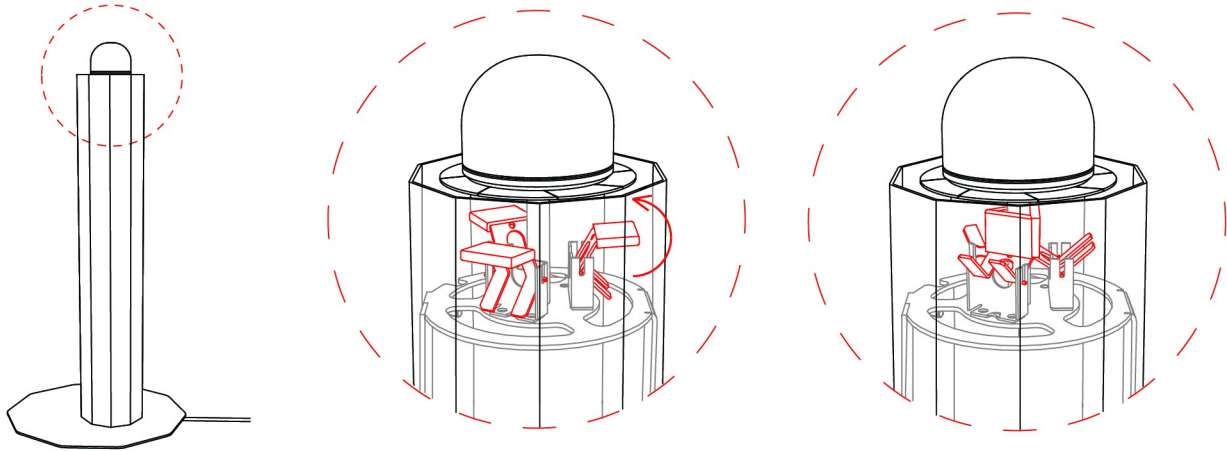

2. INSTALLING THE SHADE 2/2

Insert the shade into the metal fixture. Gently pull it upwards to ensure it is locked in place.

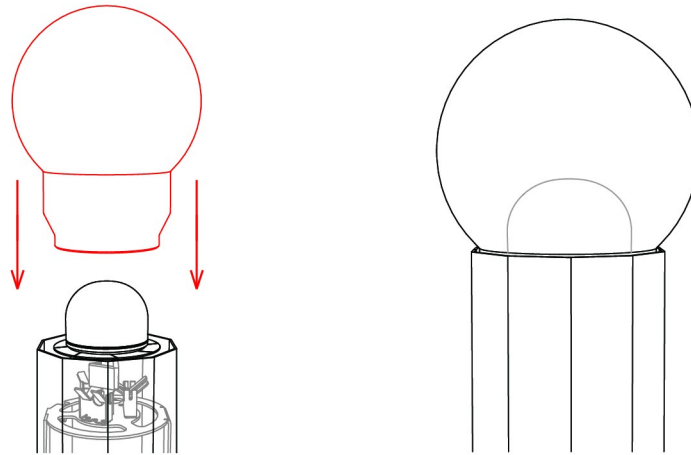

3. SWITCHING ON THE LIGHT

Plug the light into an electrical outlet and verify that it works properly.

