



COMPONENTS OF PACKAGING:

2x ceiling holder with canopy and electrical components,
8x connecting terminal block, 4x adjusting screw (worm)
M5x25,
1x Allen key size 1.5, 1x Allen key size 2.5, 2x connecting cable,
2x plastic cable stop, 1x luminaire, 2x spotlight,
1x pair of cotton gloves,
1x installation manual

WARNING:

**Installation must be carried out by a
qualified electrician only.**

**Switch off power at main circuit panel
prior to installation!**

**The manufacturer assumes no liability
for damage occurring during transport
or resulting from incorrect installation.**

Installation time: 45min. / 1 persons



BROKIS

BROKIS S.R.O.
ŠPANILOVA 1315/25
163 00 PRAHA 6 - ŘEPY
CZECH REPUBLIC

ORG. ID 64940799
VAT ID CZ64940799
C 42174 MĚSTSKÝ SOUD
V PRAZE

TEL +420 567 211 517
TECHNICAL@BROKIS.CZ
INFO@BROKIS.CZ
WWW.BROKIS.CZ

1. INSTALLING THE CEILING BRACKETS

Using anchors of sufficient strength (not included), secure the first ceiling bracket to the ceiling. Next, secure the second ceiling bracket to the ceiling at a distance of 395 mm from the centre of the first bracket. With regard to various types of ceilings, we recommend consulting installation with an expert. The manufacturer assumes no liability for incorrect installation, the use of improper anchors, or defects in the material to which the brackets are secured.

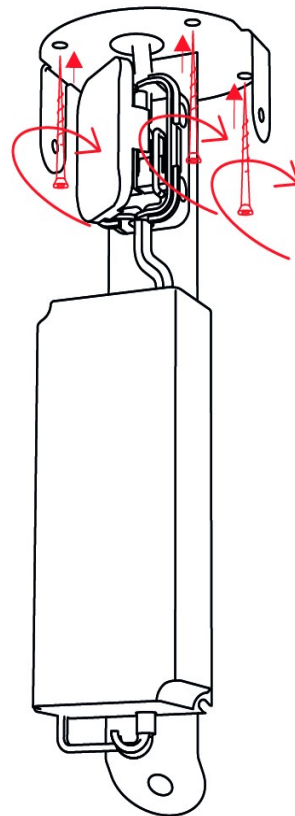

2. INSTALLING THE POWER CABLE

Pass the power cable through the glass ceiling canopy, the grommet, and the plastic cable stop in the bracket. Next, tighten the screw in the plastic cable stop with at least 1–1.5 Nm of force.

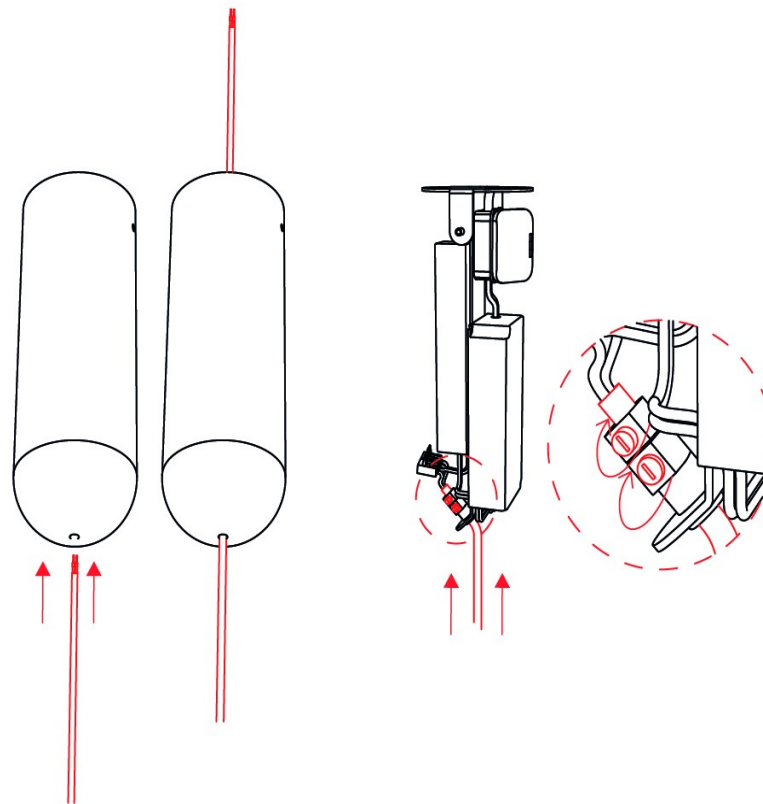

3. CONNECTING THE LIGHT TO THE BUILDING WIRING

Connect the light to the building wiring according to the connection diagram. Care must be taken to ensure the individual wires are stowed in the terminal box.

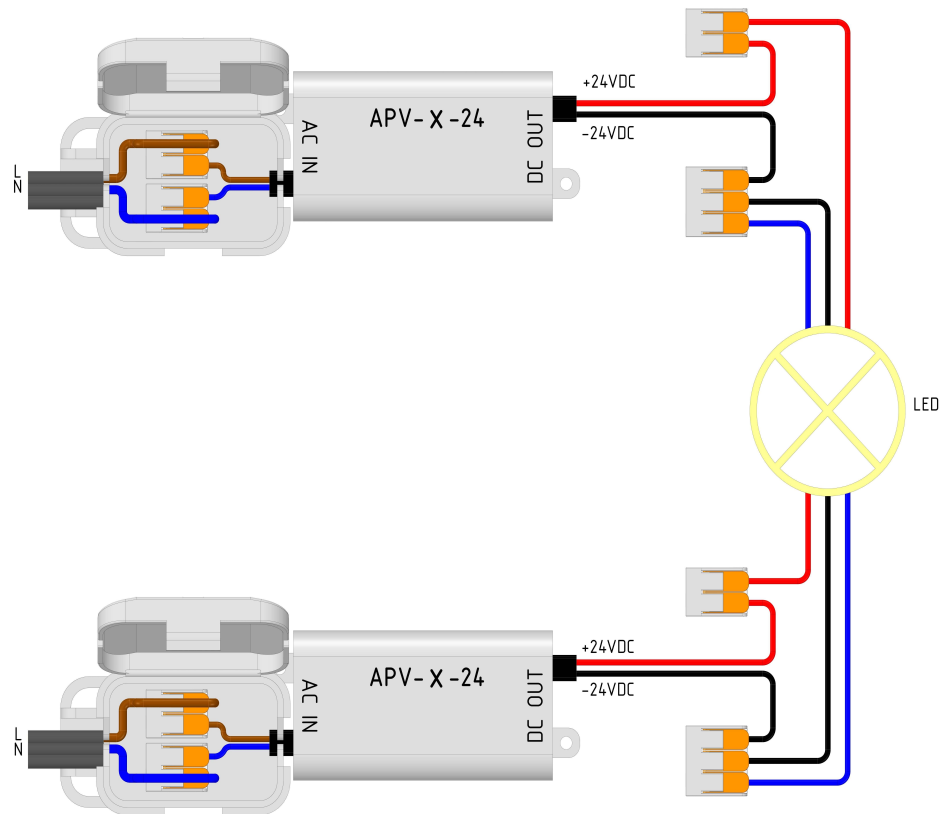

4. INSTALLING THE GLASS CEILING CANOPY

Position the glass ceiling canopy on the ceiling bracket and secure it with the M5x25 mm screws using the 2.5 mm hex key. Ensure the screws extend at least 5 mm from the ceiling canopy.

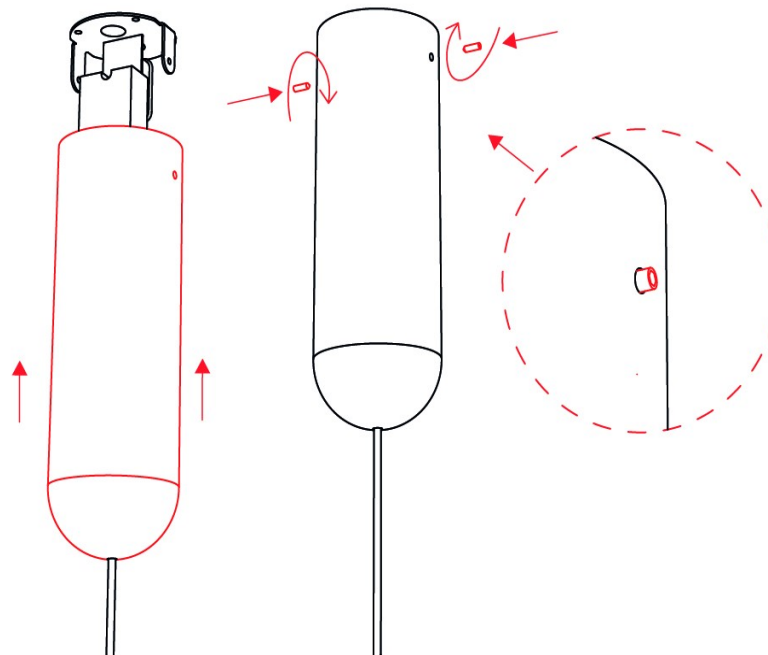

5. INSTALLING THE TUBE LIGHT

On the power cable, use the 1.5 mm hex key to loosen the screw holding the sleeve in place. Connect the power cable to the tube light by joining the two halves of the connector. To complete the process, turn the sleeve to conceal the connector and then retighten the sleeve screw. Repeat the steps for the second connector.

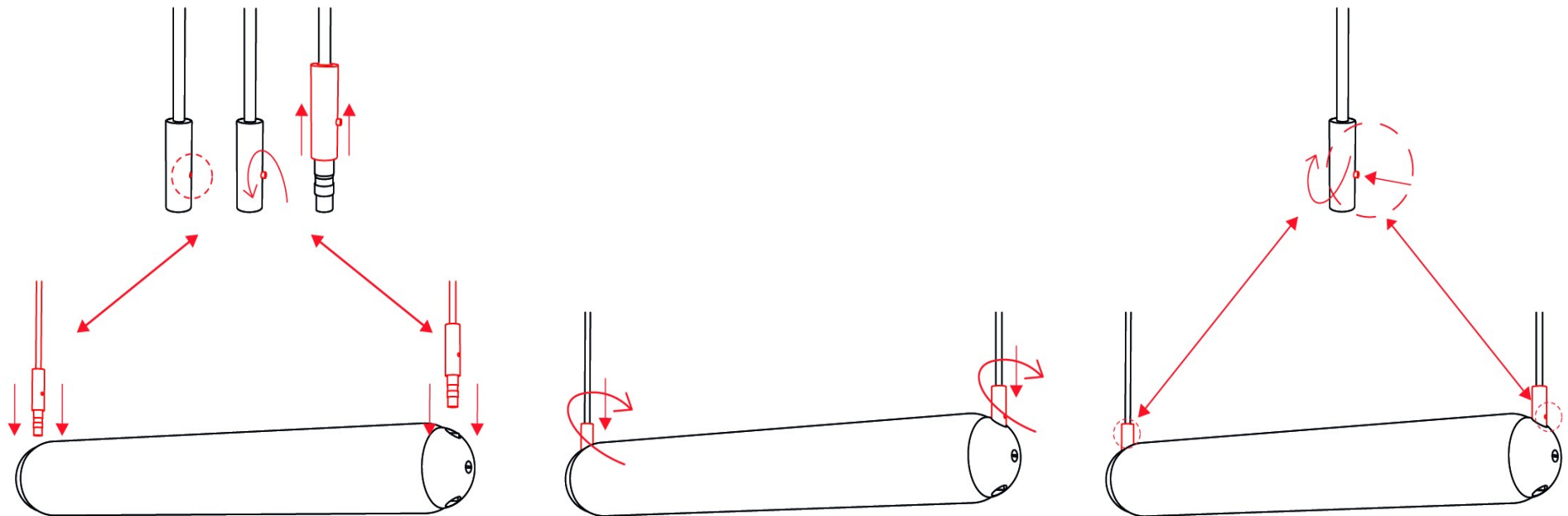

6. INSTALLING THE BELL LIGHTS

On the bell light power cable, use the 1.5 mm hex key to loosen the screw holding the sleeve in place. Connect the bell light to the tube light by joining the two halves of the connector. To complete the process, turn the sleeve to conceal the connector and then retighten the sleeve screw. Repeat the steps for the second bell light.

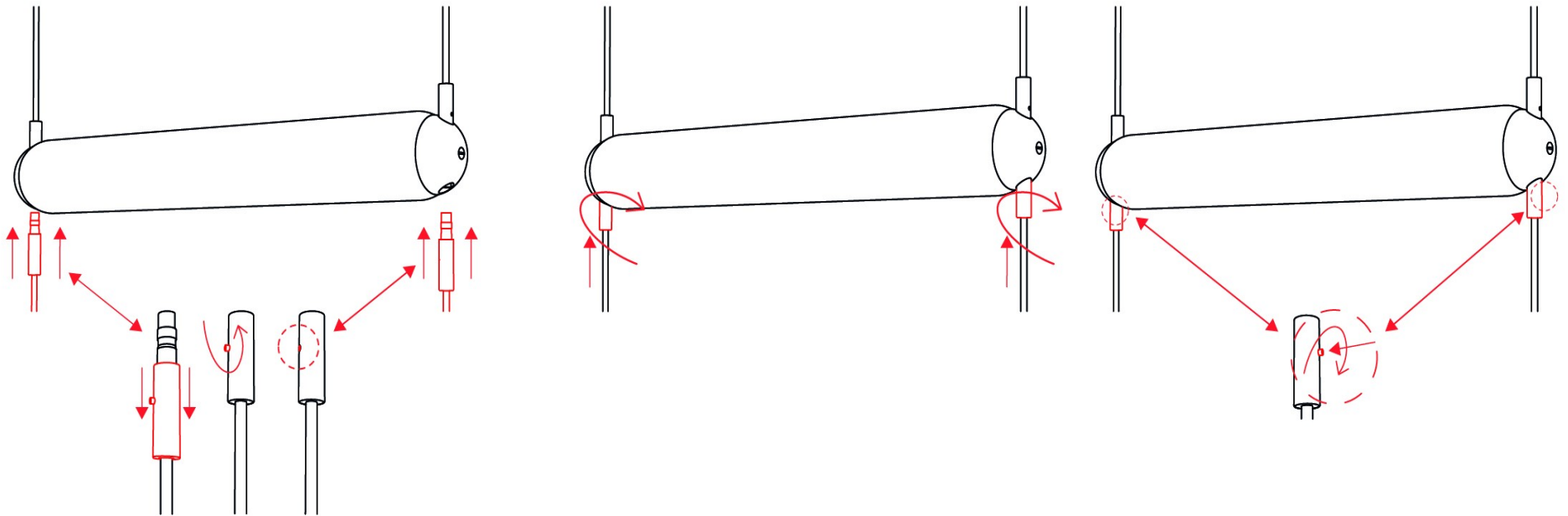

7.



The luminaire can be treated with common cleaning agents. Do not use solvents or abrasive cleaners (powders).

PRIOR TO SHIPPING, THE FUNCTIONALITY OF EACH LIGHT AND ITS COMPONENTS IS THOROUGHLY TESTED. THE MANUFACTURER ASSUMES NO LIABILITY FOR THE MISHANDLING OF PRODUCTS.



BROKIS

BROKIS S.R.O.
ŠPANIELOVA 1315/25
163 00 PRAHA 6 - ŘEPY
CZECH REPUBLIC

ORG. ID 64940799
VAT ID CZ64940799
C 42174 MĚSTSKÝ SOUD
V PRAZE

TEL +420 567 211 517
TECHNICAL@BROKIS.CZ
INFO@BROKIS.CZ
WWW.BROKIS.CZ