

BROKIS®

BIG ONE

CM12096

PC1043, PC1044



Download

COMPONENTS INCLUDED WITH UNIT:

1x two-piece core with magnets on suspension ring
1x ceiling canopy bracket
1x ceiling canopy
1x outer shade
1x glass cover
3x wire rope stop
2x hex screw (M4)
1x hex key size 2
1x hex key size 2.5
1x spirit level
2x connector terminal
1x cotton gloves
1x installation manual

WARNING:

**Installation must be carried out by
a qualified electrician only.**

**Switch off power at main circuit panel prior to
installation!**

**The manufacturer assumes no liability for
damage occurring in transport or resulting
from incorrect installation.**

Installation time: 1 hour / 2 persons



BROKIS®

BROKIS S.R.O.
ŠPANELOVA 1315/25
163 00 PRAHA 6 - ŘEPY
CZECH REPUBLIC

ORG. ID 64940799
VAT ID CZ64940799
C 42174 MĚSTSKÝ SOUD
V PRAZE

TEL +420 567 211 517
TECHNICAL@BROKIS.CZ
INFO@BROKIS.CZ
WWW.BROKIS.CZ



CLEANING THE GLASS

BROKIS applies the highest possible quality standards in manufacturing its lights. Prior to shipping, each light undergoes several quality controls and stages of cleaning. Lights may require additional cleaning as a result of transportation, storage, and the amount of time that passes between packing in our plant and subsequent unpacking by the client. Therefore, we emphasize cleaning the lights prior to installation.

The glass must first be rinsed in hot water, with a dilution of a dish-detergent used to remove all foreign particles and dust. Eventually repeat this basic treatment, if necessary. Afterwards the glass must have a second cleaning using hot water, with a dilution of a de-greaser (such as ammonia or vinegar). The glass must then be thoroughly rinsed with running hot water. Eventually repeat this treatment, if necessary. The glass is then thoroughly dried with a paper towel or a clean soft cotton towel. Only re-assemble the glass to the lamp body, when completely cooled down.

Do not use mineral spirits, highly concentrated thinners, or other substances not intended for use on glass surfaces. Also: do not use products, containing silicones – since they will rapidly attract more dust and grease.

PRIOR TO SHIPPING, THE FUNCTIONALITY OF EACH LIGHT AND ITS COMPONENTS IS THOROUGHLY TESTED. THE MANUFACTURER ASSUMES NO LIABILITY FOR THE MISHANDLING OF PRODUCTS.



1. INSTALLING THE CEILING BRACKET AND LOAD-BEARING TUBES OF THE WIRE ROPE STOPS

Use anchors of sufficient strength (not included). With regard to various types and conditions of ceilings, we recommend consulting installation with an expert. The manufacturer assumes no liability for incorrect installation, the use of improper anchors, or defects in the material to which the bracket is secured.

Position the paper template on the ceiling and mark three points. Secure the load-bearing tubes of the wire rope stops to these points. Next, secure the canopy bracket to the ceiling.

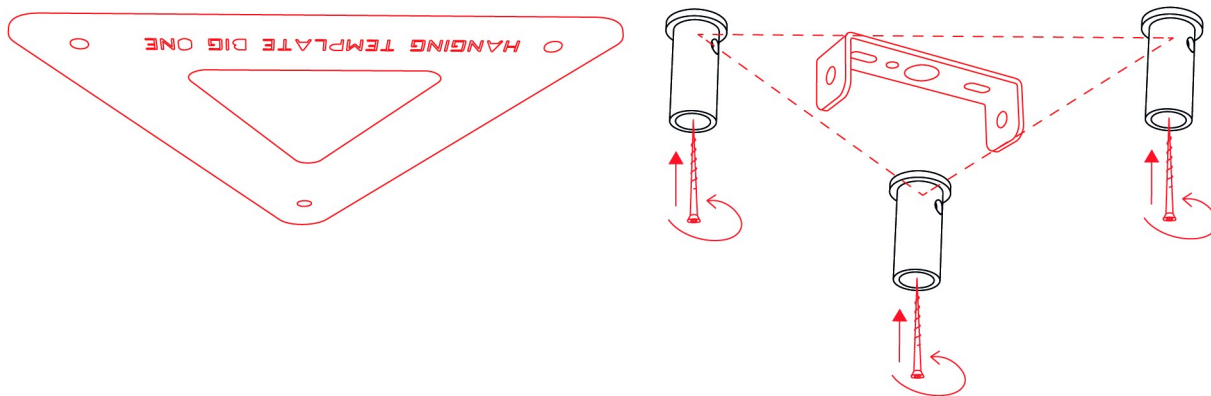

2. INSTALLING THE WIRE ROPES

PRIOR TO INSTALLATION, REMOVE THE UPPER SECTION OF THE GLASS CORE!

Pass the wire rope through the first part of the load-bearing tube, the so-called safety. Unscrew the second part of the load-bearing tube and slide it over the wire rope (ensure the end of the wire rope is not frayed). Press the two parts together to secure the wire rope. Next, pass the wire rope through the hole in the side of the load-bearing component. Never trim the wire rope before completing installation. Adhering to these steps ensures safe anchoring of the wire rope.

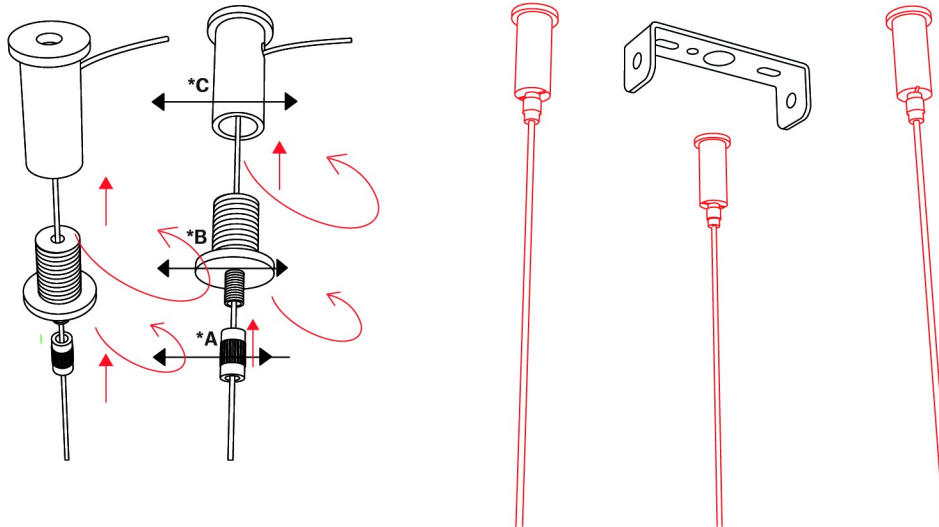

3. BALANCING THE LIGHT

Use the spirit level included with the light to check the alignment of the core suspension ring. Make minor adjustments to the length of the wire ropes by loosening and pressing the safety on the load-bearing tube. Once the light is balanced, secure the safety by retightening it.

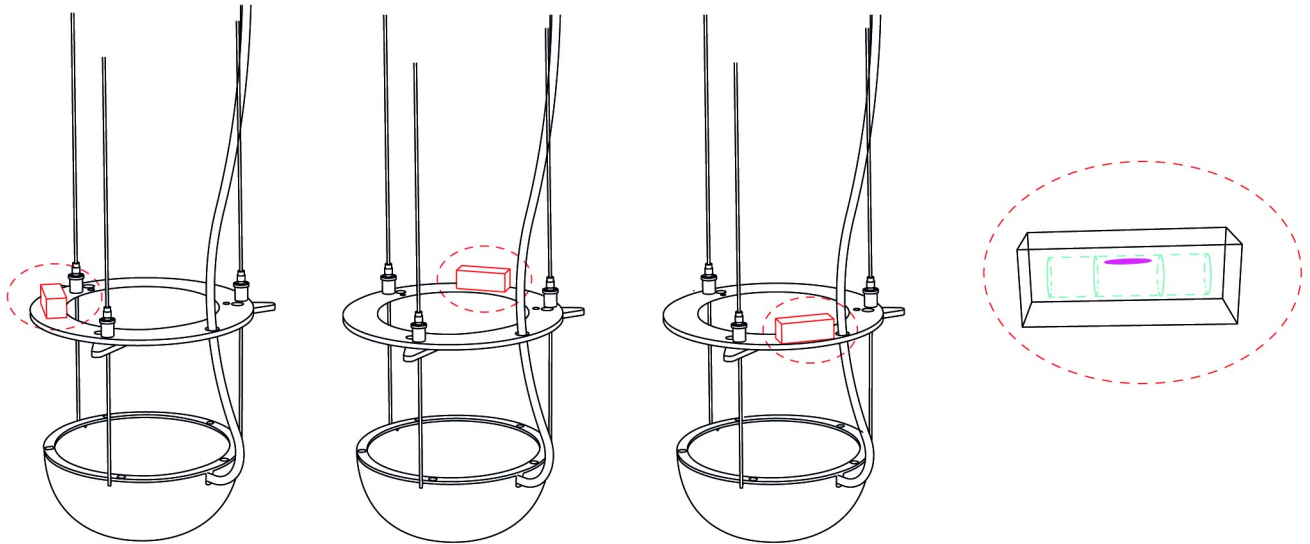

4. INSTALLING THE LIGHT SOURCE AND ASSEMBLING THE CORE

Install the light source (G9) in the socket in the bottom half of the inner globe and then position the upper half over the bottom half. Ensure the magnets at the edges of each half of the inner globe are aligned with one another.

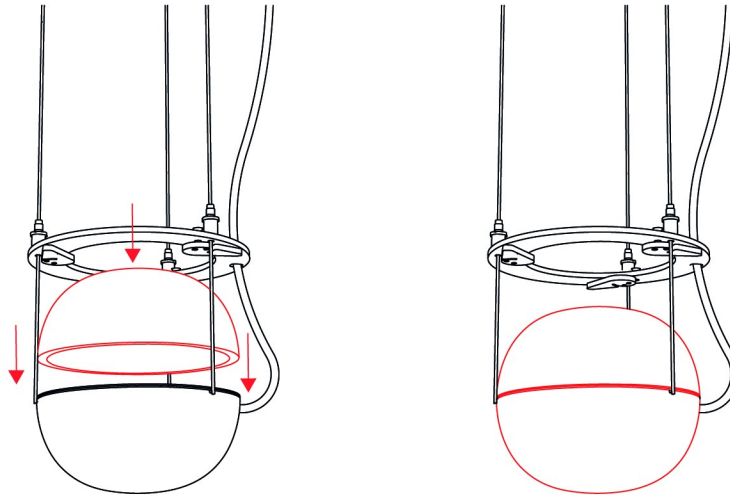

5. CONNECTING THE LIGHT TO THE BUILDING WIRING

Connect the light to the building wiring according to the connection diagram. Care must be taken to ensure the individual wires are stowed in the terminal box.

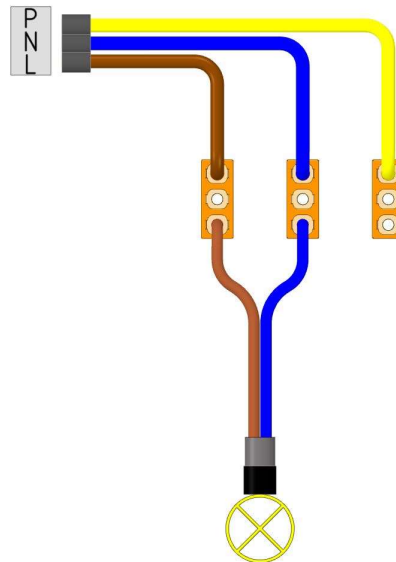

6. INSTALLING THE CEILING CANOPY

Using the two set screws and the hex key, secure the ceiling canopy to the bracket.

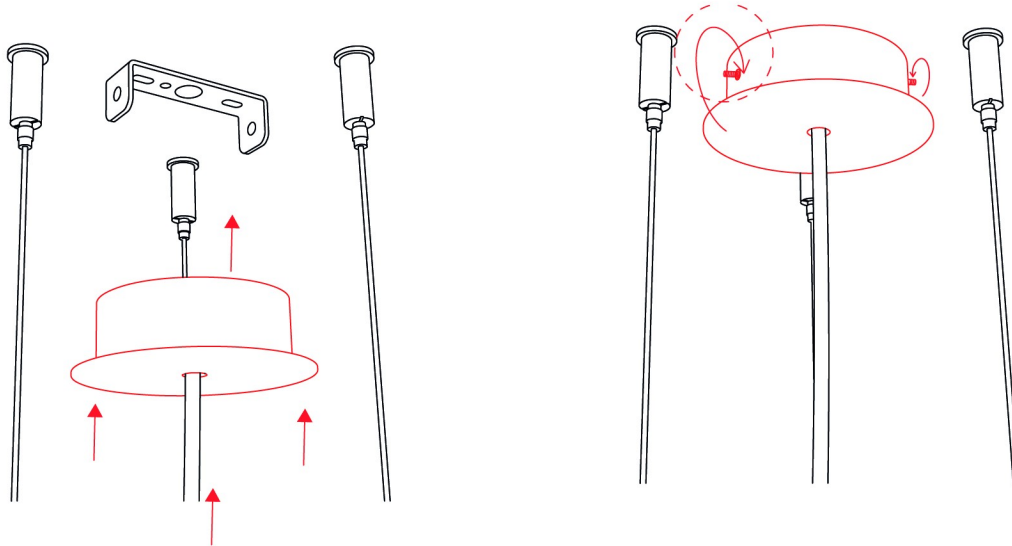

7. INSTALLING THE LIGHT – UNLOCKING THE SUSPENSION LEVERS

Using the hex key size 2.5 loosen the three M4x8 screws. Rotate the three suspension levers to the left so that they do not protrude beyond the edge of the suspension ring.

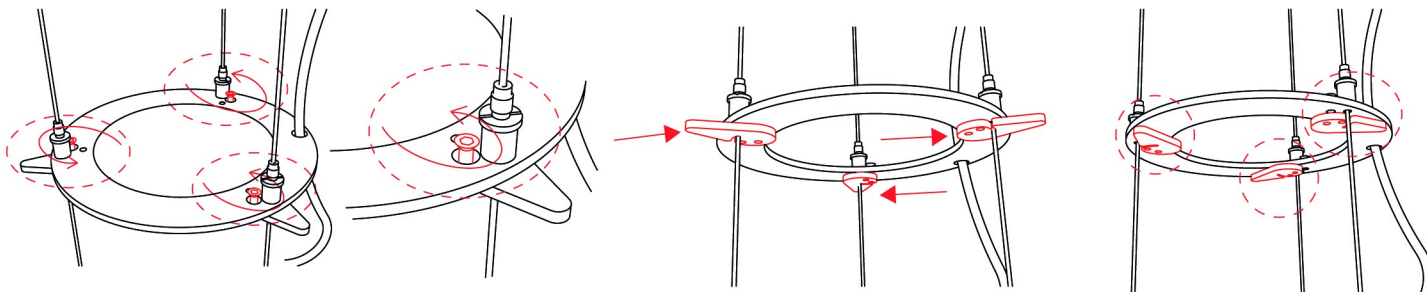

8. INSTALLING THE OUTER GLOBE

Lift the outer globe over the inner globe until its opening is slightly higher (no more than 50 mm) than the suspension ring. Return the suspension levers unlocked in step 4 to their original positions and secure them with the three M4x8 screws. Ensure the suspension components have been properly secured to prevent unwanted shifting, and then gently lower the outer globe onto them.

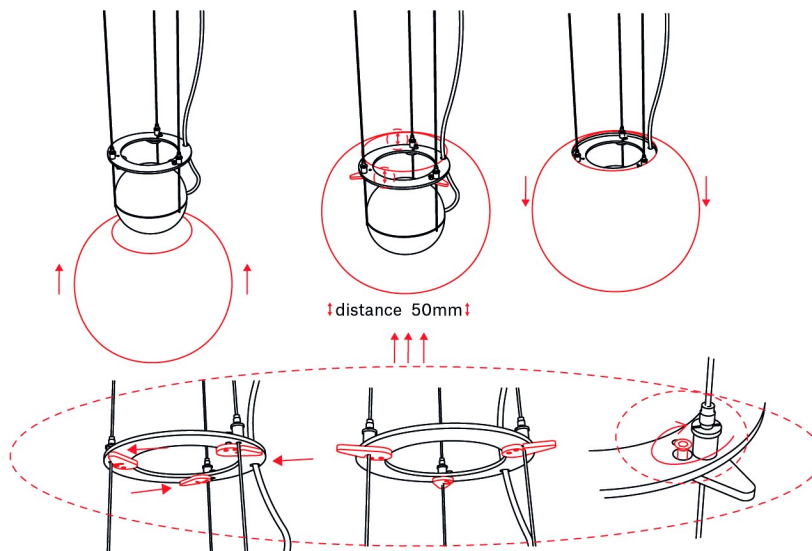

9. SWITCHING ON THE LIGHT

Restore power at the main circuit panel and verify that the light works properly.

