

# DOCUS

17-Dec.-2016

## 1.0 LED

LED 8W | 220-240VAC | 50-60Hz | COB 2-step | incl. PS | phase-cut dim

CE IP20 0.3m 36°

white texture	146364W
aluminium brushed	146364L
gold	146364G
copper	146364P
black texture	146364B

### LIGHT COLOUR

2700K   >80CRI   600lm	2
3000K   >80CRI   600lm	4
1800-2850K   >90CRI   410lm	9

## 1.0 PAR16

PAR16 max. 35W | GU10 | 100-240VAC | 50-60Hz

CE IP20 0.9m

white texture	146320W0
aluminium brushed	146320L0
gold	146320G0
copper	146320P0
black texture	146320B0

### OPTIONAL

for PAR16 lamps see our catalogue

### OPTIONAL

single inner cover max. 10W

white texture	911021W1
gold	911021G1
black texture	911021B1

### base plate dimensions

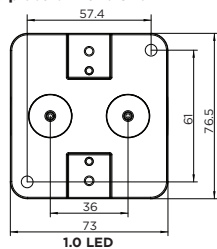

1.0 LED

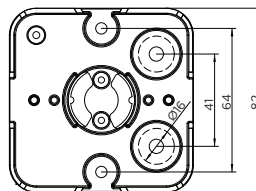

1.0 PAR16

### 1.0 LED

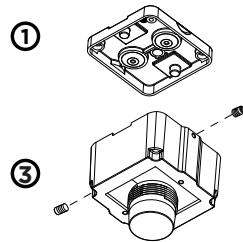

### 1.0 PAR16

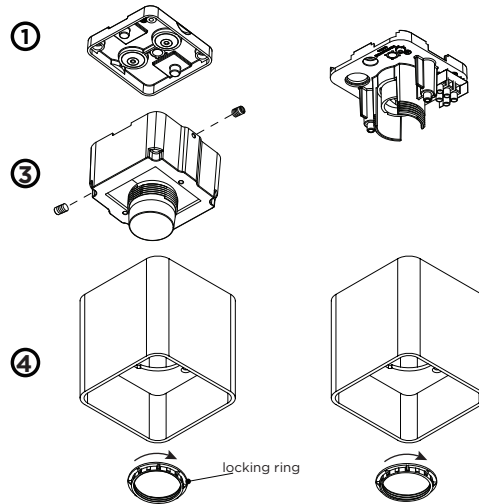

or

or

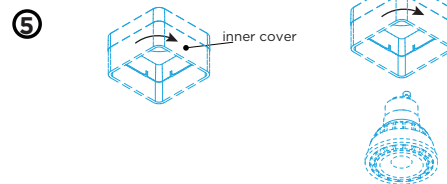

inner cover

## DIMENSIONS

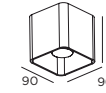

1.0 LED

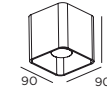

1.0 PAR16

## 1 MOUNTING INSTRUCTION

Remove the screws of the top part, put the cables through the opening and mount the base on the ceiling.

## 2 POWER CONNECTION

Connect wiring to the power supply (for LED) or to terminal block (for PAR16)  
interior connection: STANDARD version

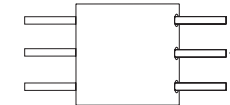

STANDARD

## 3 FOR LED

Attach the LED housing on the base by two allen screws.

## 4 FOR LED

Attach the DOCUS cover to the LED housing by screwing the locking ring

## FOR PAR16

Attach the DOCUS cover to the base by screwing the locking ring

## 5 OPTIONAL inner cover

put the inner cover in the outer cover by screwing.

with inner cover: **max. 10W**

when using the inner cover you don't need the locking ring.



WEVER & DUCRÉ  
LIGHTING

www.weverducre.com

Wever & Ducre bvba Kwadestraat 153 bus 2.1 8800 Roeselare

INSTALLATION  
INSTRUCTIONS