

MATCH WALL

INSTALLATION INSTRUCTIONS | MAY 2023

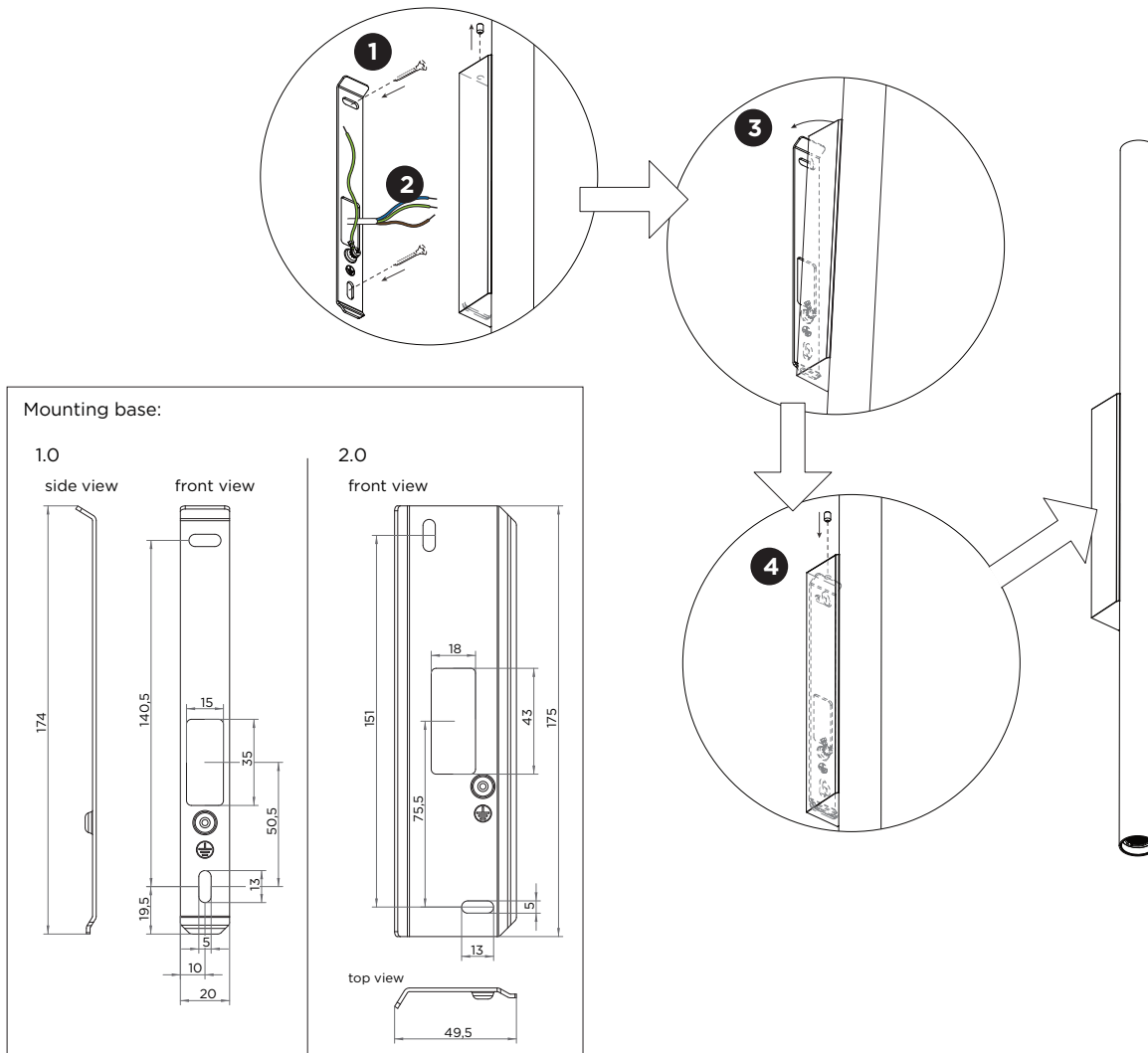

DIMENSIONS

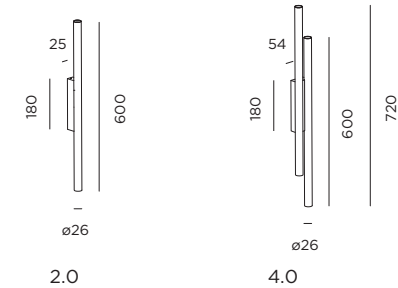

1 Remove the mounting base from the luminaire by loosening the side socket screw and mount it on the wall with screws (screws are not included).

2 POWER CONNECTION

Connect to 220-240V.

2.0

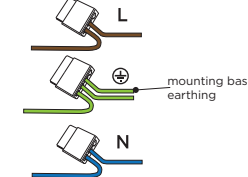

4.0

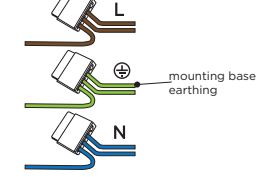

3 Attach the luminaire to the mounting base by putting the grooves of the housing to the flatter end of the mounting base first, and then tilting towards the wall as shown.

4 Fix the luminaire on the base with the socket screw.

MATCH WALL

INSTALLATION INSTRUCTIONS | MAY 2023

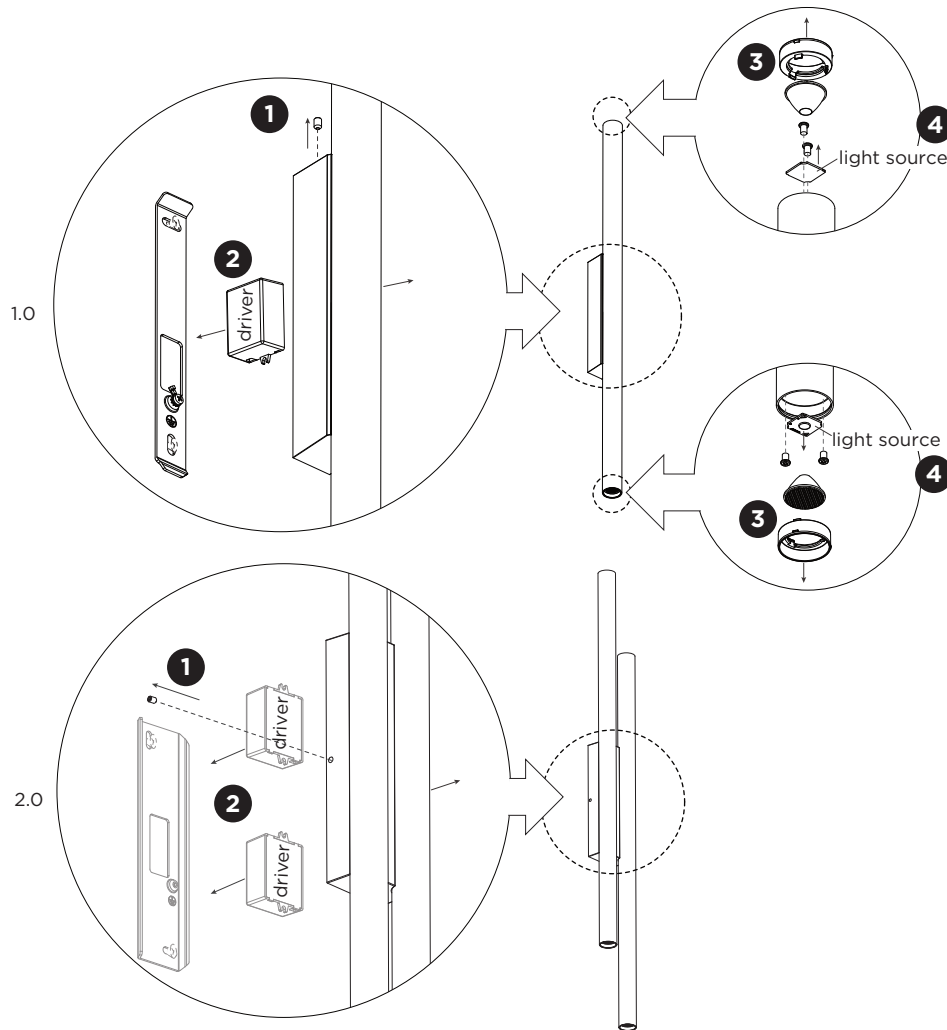

DISMOUNTING AND RECYCLING INSTRUCTIONS

Light source & driver

- 1 Loosen the socket screw, disconnect the wires, and remove the fixture from the mounting base.
- 2 Disconnect the wires and remove the driver(s).
- 3 Pull out the fixing ring(s), remove the lens(es).
- 4 Unscrew the screws, disconnect the wires and remove the light source(s).

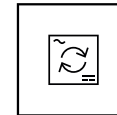

The driver can be replaced by the end user.



The light source is replaceable by an authorized professional.
For advice contact your Wever & Ducré customer service contact point.



This luminaire contains a light source with the energy class E.